

DVSL-500C / 501C

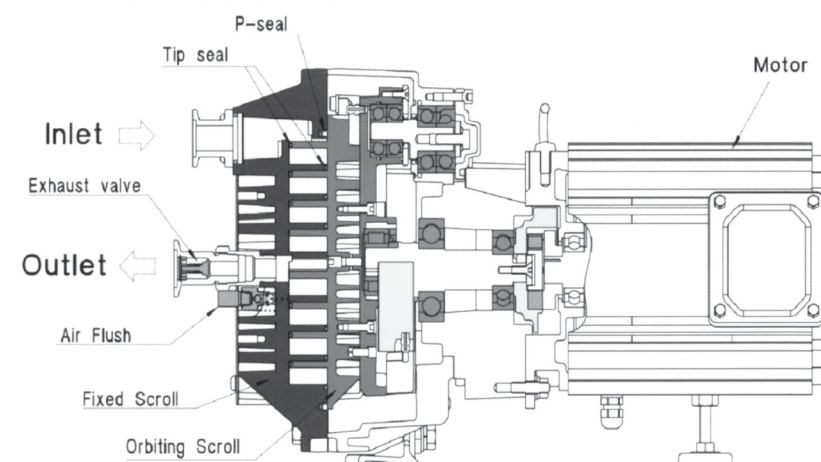

DVSL Series

Welcome to the Anest Iwata product line of Synergy Systems Corporation. SynSysCo's Principals and Anest Iwata have a long-standing relationship that began in 1998. Together we established the original commercial relationship that introduced the Anest Iwata brand to North America and established its service and support centers.

Since this introduction, the Anest Iwata brand has become the Market Standard for Scroll pump performance. Their products have been widely received by all aspects of the Industry, Academia, and Federal Research Institutions.

Anest Iwata is the original manufacturer to bring scroll vacuum pumps to the vacuum market. With nearly 20 years of field experience and more performance hours than all its competitors combined, the ISP series scroll vacuum pumps are the premium choice for clean pumping technology.

SynSysCo is pleased to distribute Anest Iwata products in North America, and we are able to service and support all your scroll pump application needs. Please feel free to contact us for any service, new product selection, or system configuration inquiries you may have. We look forward to hearing from you.



Dry Scroll Vacuum Pump



DVSL-100C

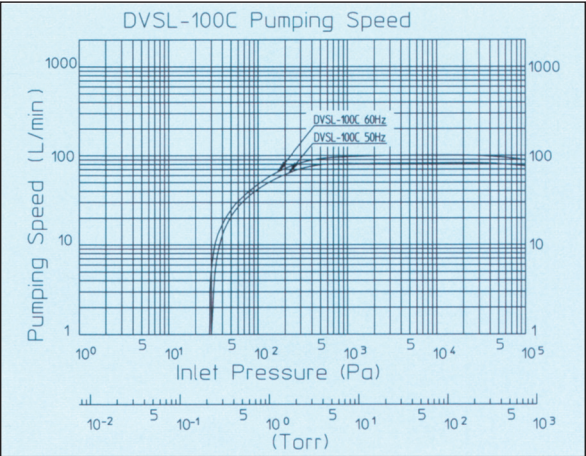
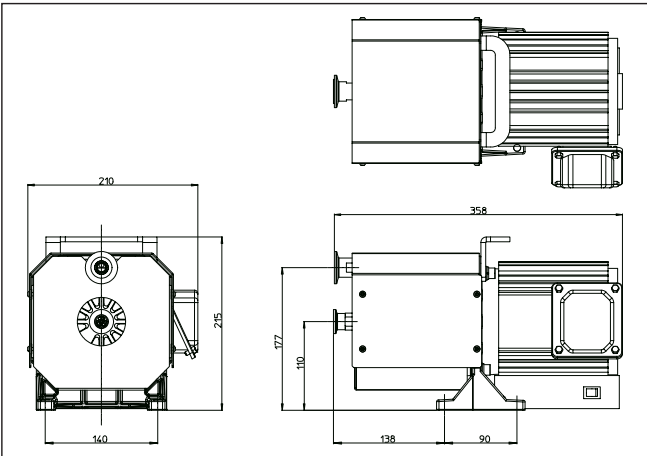

Trade Name		DVSL-100C	
Model		DVSL-100C	
Pumping Speed	L/min (CFM) 50/60 Hz	100/120 (3.5/4.2)	
Ultimate Pressure	Pa(Torr)	≤ 50 (3.8x10 ⁻¹)	
Motor Power	W	300	
Voltage	V	1Ph	100, 115, 200, 230
		3Ph	-
Noise Level	dB (A)	65	
Noise Level (at air-flush)		68	
Weight	kg	1Ph	15
		3Ph	-
Water Vapor Capacity	g/day	100	
Air Flush	L/min	5	
Inlet Connection	NW	25(with RC 3/8)	
Outlet Connection	NW	16	
Cooling System		Air-Cooled	
Ambient Temperature	°C / °F	5 ~ 40 / 41 ~ 104	
Back-up Material		Fluorine rubber	

Features

- DVSL scroll pump is equipped with dry vacuum system without using lubricating oil or sealing water.
- No gears result in no need to exchange gear oil and no risk of leaking lubricating oil.
- Easy – maintenance available.
- Generated clean vacuum keeps installation area clean.
- Excellence in displacing water vapor.
- Reliable Design – little power variance between atmospheric pressure and the ultimate pressure allows repeated continuous operation between atmospheric pressure and vacuum.
- Standard equipped hour meter enables easy daily operation. Only supplied with DVSL-500C /501C.
- Excellence in energy-savings in vacuum area. 24 hrs operation secured.



DVSL-500C/501C

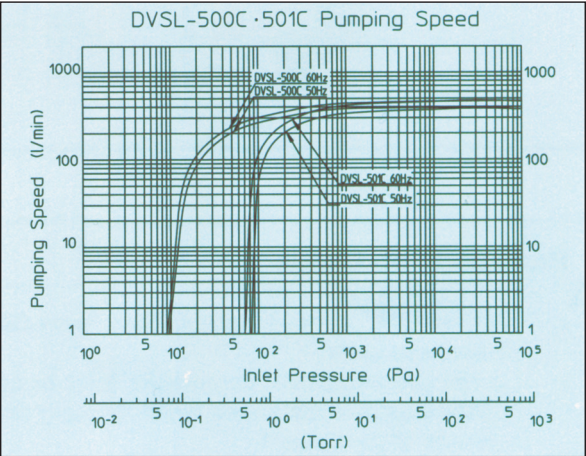
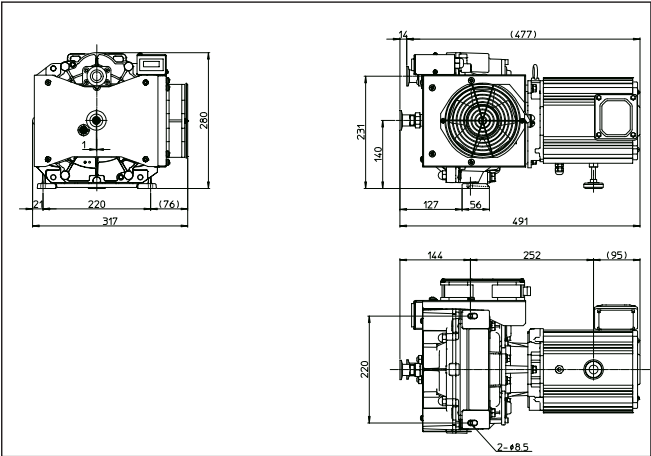

Trade Name					
Model		DVSL-500C		DVSL-501C	
Pumping Speed	L/min (CFM) 50/60 Hz	430/520 (15.2/18.4)			
Ultimate Pressure	Pa(Torr)	≤ 30 (2.3x10 ⁻¹)		≤ 100 (7.5x10 ⁻¹)	
Motor Power	W	900/1100			
Voltage	V	1Ph	-		
		3Ph	200, 208, 230, 380, 415, 400, 460		
Noise Level	dB (A)	64			
Noise Level (at air-flush)		69			
Weight	kg	1Ph	-		
		3Ph	36		
Water Vapor Capacity	g/day	250			
Air Flush	L/min	10			
Inlet Connection	NW	25(with RC 1/2)			
Outlet Connection	NW	25			
Cooling System		Air-Cooled			
Ambient Temperature	°C / °F	5 ~ 40 / 41 ~ 104			
Back-up Material		Silicon rubber		Fluorine rubber	

Applications

- Vacuum Chuck
- Vacuum Transport
- Vacuum Forming
- Deaerator
- Gas Substitution
- Vacuum Drying
- Vacuum Packing
- Cryopump Regeneration
- Leak Test
- Roughing for TMP

Air Flush

Purpose of Air Flush - Pumping humid gas with a vacuum pump can cause condensed moisture to remain in the pump. This remaining moisture can cause a failure to the pump or ultimate pressure. The Air Flush operation is necessary to remove remaining moisture. The Air Flush operation not only removes the remaining moisture but recovers ultimate pressure.